

HA7000 Blower™

Specifications

Rated voltage: 220-240VAC, 50 Hz,
IP rating: IPX4

Dimensions & temperatures

Weight: 1.576 kg
Operating temperature: 0 to 50°C
Storage temperature: -20 to 50°C

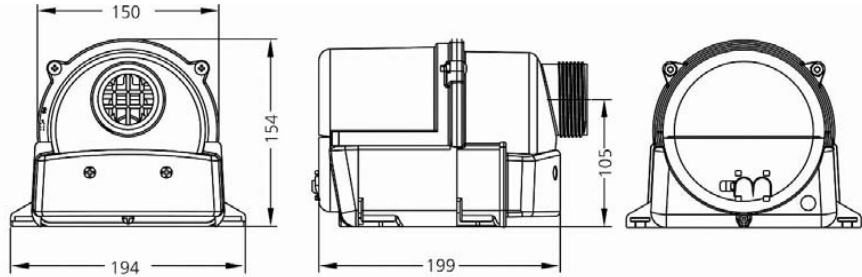

No air switch	No air switch + heater	Air switch	Air switch + heater	Rated power	Rated current
22-7350		22-73501		350W	1,5A
	22-7352		22-73521	650W	2,9A
22-7450		22-74501		450W	2,0A
	22-7452		22-74521	750W	3,4A
22-7600		22-76001		600W	2,6A
	22-7602		22-76021	900W	4,1A

Note : Models are available with AMP connector upon request (Eg. 22-7600-AMP)

Note

The standard version of the HA7000 air blower is constructed for use on whirlpools, spas and similar applications for private use only. The HA7000 air blower is not constructed for use together with a separate portable mat and must never be used as a portable unit.

Location

The HA7000 air blower must be mounted in a suitable place which does not allow accessibility without use of a tool and is protected from flooding. It must also be placed in a well-ventilated location, but avoid cold air intake as this will cause a cold air injection into the whirlpool or spa.

Installation

The blower is suitable for mounting below whirlpools and spas. It must be secured to the installation place and we recommend that the blower be placed horizontally. The blower should not be accessible to people using the whirlpool or spa. Water flowing back from the whirlpool or spa must not come into contact with the blower. To ensure this, we recommend that the pipe or hose system be laid so that a double air loop and one or two check valves are fitted above the maximum water level. The pipe/hose system must be securely fixed to the blower's outlet. For pneumatically controlled air blowers, flexible piping with an internal diameter of 3 mm. must be fitted to the air switch which is located at the back of the blower. Note: In Germany the installation must be done according to the standard DIN VDE 0100-701.

(over)

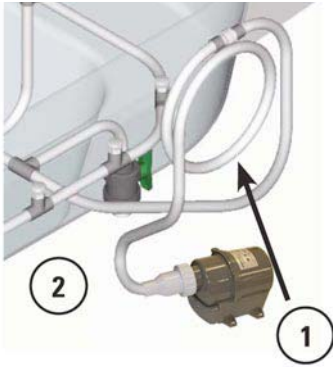

Warning

1. It is essential that the pipe or hose system always has a double air loop and one check valve, or two check valves, fitted above the maximum water level.
2. Connect blower discharge to air piping on whirlpool before connecting power to the blower.

Important

The appliance is not to be used by children or persons with reduced physical, sensory or mental capabilities, or lack of experience and knowledge, unless they have been given supervision or instruction (IEC 60335-1/A2). Children being supervised must not play with the appliance (IEC 60335-1/A2).

Electrical installation

- Note: All electrical work must be carried out by a qualified electrician according to national wiring rules.
- Electrical installations should not be done until the blower is completely installed in its location.
- Check the main voltage before connecting the blower.

The blower is fitted with an electrical supply cord and has the following wire-colour coding:

CLASS II

Without earth cable

Neutral: Blue

Live: Brown

If the supply cord is damaged, it must be replaced by the manufacturer, its service agent or similarly qualified person in order to avoid a hazard.

The installation of the whole system must be done using a fixed wiring switch that has a contact separation of at least 3 mm. in each pole. If the single-speed blower is fitted to an external variable speed control box, the blower must run at high speed for at least 5 seconds.

Note: If the thermal protection for the air blower motor is activated, the blower will not restart until power from the system has been cut off and switched on again AFTER the blower has cooled to room temperature.

The appliance should be supplied through a residual current device (RCD), with a rated tripping current not exceeding 30 mA (IEC 60335-2-60).

Stationary appliances not fitted with means for disconnection from the supply mains must have a contact separation in all poles that provide full disconnection under overvoltage category III, (means for disconnection must be incorporated in the fixed wiring in accordance with the wiring rules)

Maintenance

No special maintenance is required for the air blower although the intake filter can be cleaned. If the power-supply cord is damaged, it must only be replaced by the manufacturer, service agent or a similar qualified agent in order to avoid damage.